

السماط البارزة:

1. آلات العنوان الباردة هذه تلقائيًا بالكامل وسهلة التشغيل مع القليل من التدريب ، مزودة بالموت الصلب لإنتاج فارغ للبراغي والمسامير والمسامير وغيرها من المكونات المماثلة. تقطع آلية القطع والضرب بأجهزة بأمان ستوقف أي حادث كبير في حالة حدوث أي وظيفة غير طبيعية في الآلات.

2. تم تقديم شرط إيجابي على اللكومات الأولى والثانية للتخلص من إمكانية الالتزام بهذه اللكومات أثناء العمليات.

3. في بعض آلات الشحن الإضافية ، سيتم تجهيزها بأجهزة القابض الهوائي وأنظمة التشحيم المركزية التلقائية التي توفر تشحيمًا كافيًا لجميع سطح المحمل



BOLT MAKER

Auto multi-station cold Upsetting Former is a specialized machine tool with high precision, high productivity and more automation among metal forging machinery.

Cold upsetting technique and cold upsetting formers are used as an important means for producing different kinds of bolts.



- Professional
- Good quality
- Energy conservation

20 YEARS

20 years of professional export

MAIN FEATURES

AIR CLUTCH

SWING
PNEUMATIC
GRIPPER

RATCHET
DRIVED BY
CYLINDER
CONTROL

LINK BLOCK
SYSTEM

IMPORTED
INVERTER

TESTING
SAFETY PIN

SYNCHRONOUS
OPERATION

REAR
KNOCK
OUT DEVICE

WEAR
RESISTANT
MATERIAL

HIGH
STRENGTH
MATERIAL

MADE BY
NC MACHINE
TOOL

OPTIONAL
FOR NC
SYSTEM

SUPER HIGH QUALITY UNITS



SWING PNEUMATIC GRIPPER



DIGITAL BAFFLING OPERATED BY HAND WHEEL



DIGITAL FEEDING OPERATED BY HAND WHEEL



SLIDING SCREWED SLEEVE OF REAR K.O.



CUT OFF PART



Due to the high accurate multi-function compound gripping mechanism, there are translational wide open gripper, nut gripper and turnover wide open gripper, and these 3 grippers can be interchanged and shared at will. However the key breakthrough design is that the turnover wide open gripper can both turn over and widely open, it expands the production range for different kinds of abnormal parts and reduces the manufacturing cost for the dies.



AIR CLUTCH



OPERATING
SYSTEM

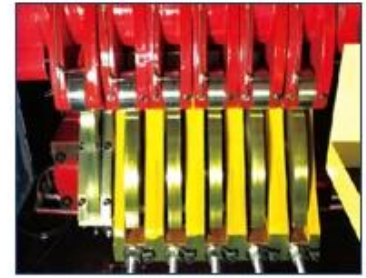

REAR KNOCK
OUT MECHANISM



ELECTRICAL
DIGITAL FEEDING

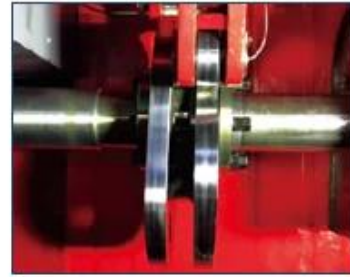

THE SWING OF
GRIPPER IS DRIVEN
BY CONJUGATE CAM



High accuracy main sliding block is designed to be connected with rear wing for letting it run stably and precisely, the bottom of front and back wing is adopted super wearing inserted copper plate with self lubrication, it can ensure accuracy and extend service life. The post stations of punching tool can be fulfilled the function of reverse punching.

HIGH QUALITY SPARES

Machine production is guaranteed to extend the service life of the machine and reduce the frequency of replacement

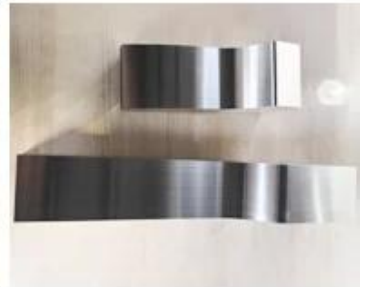
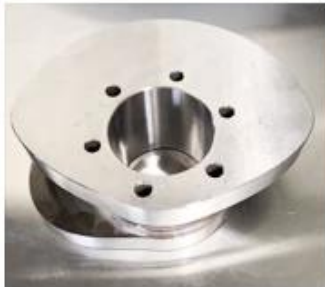
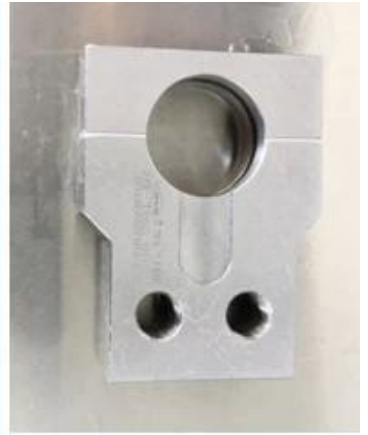

PRODUCT DISPLAY

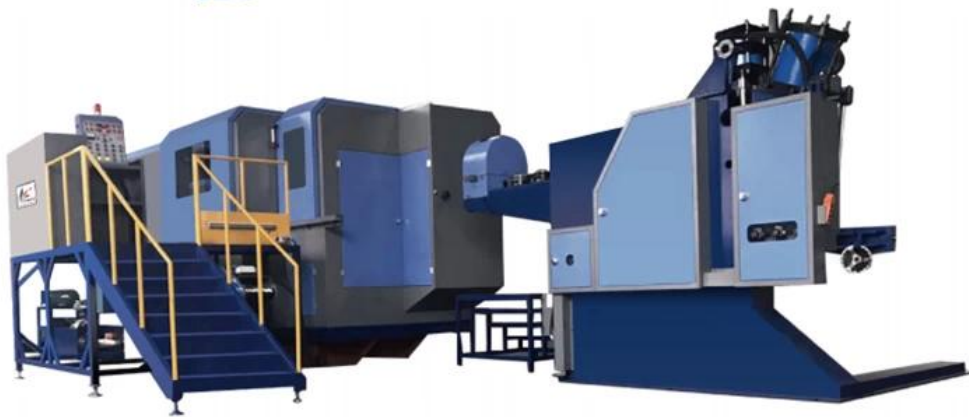
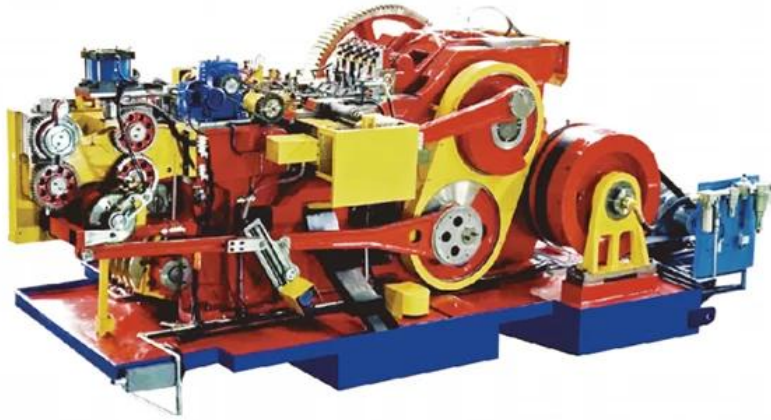



We abide by the principles of honesty, credibility, and mutual-benefit, and do our best to serve clients and customers both at home and abroad. With our top-notch professional knowledge and trading experience, we have seen our market development ability and actual business growth with an increasingly faster pace. We sincerely look forward to working with you to facility your company's foreign market development and China market expansion. Let's build a great future together!



ABROAD CUSTOMERS



OFFICE IN INDIA



STUTTGART EXHIBITION IN 2019





MUMBAI EXHIBITION IN 2019



SHIPPMENT

